

## THE COMMUNITY OF LENDRUM PLACE

### NEW PLAYGROUND

**PARK REDEVELOPMENT | About | News | Spray Park | Donate & Support | FundScrip Gift Cards**

Contact: Allison Nitchke at [playground@lendrum.org](mailto:playground@lendrum.org) for more information

---

---



**The playground grand opening on October 3rd, 2015, was a great success.**

Greetings and congratulations were brought from Lori Sigurdson (MLA for Edmonton Riverview and Minister of Advanced Education and Minister of Jobs, Skills, Training and Labour), Mayor Don Iveson and Councillor Michael Walters on behalf of the province and the city.



Joe Kostler brought greetings from the Alberta Recycling Management Authority, who helped to fund the amazing rubber surfacing.



The celebrations and BBQ saw Lendrum residents new and old come out to enjoy each other's company and check out the new playground. It was also an opportunity for everyone to brainstorm new ideas for Phase 2 of the redevelopment.

MORE PICTURES ON LendrumYEG ON FACEBOOK...

The final cost for the playground was \$403 904. Thanks again to everyone who made the playground and the event happen.

Your contributions are what make our community so amazing.



# Lendrum gratefully acknowledges our playground funders



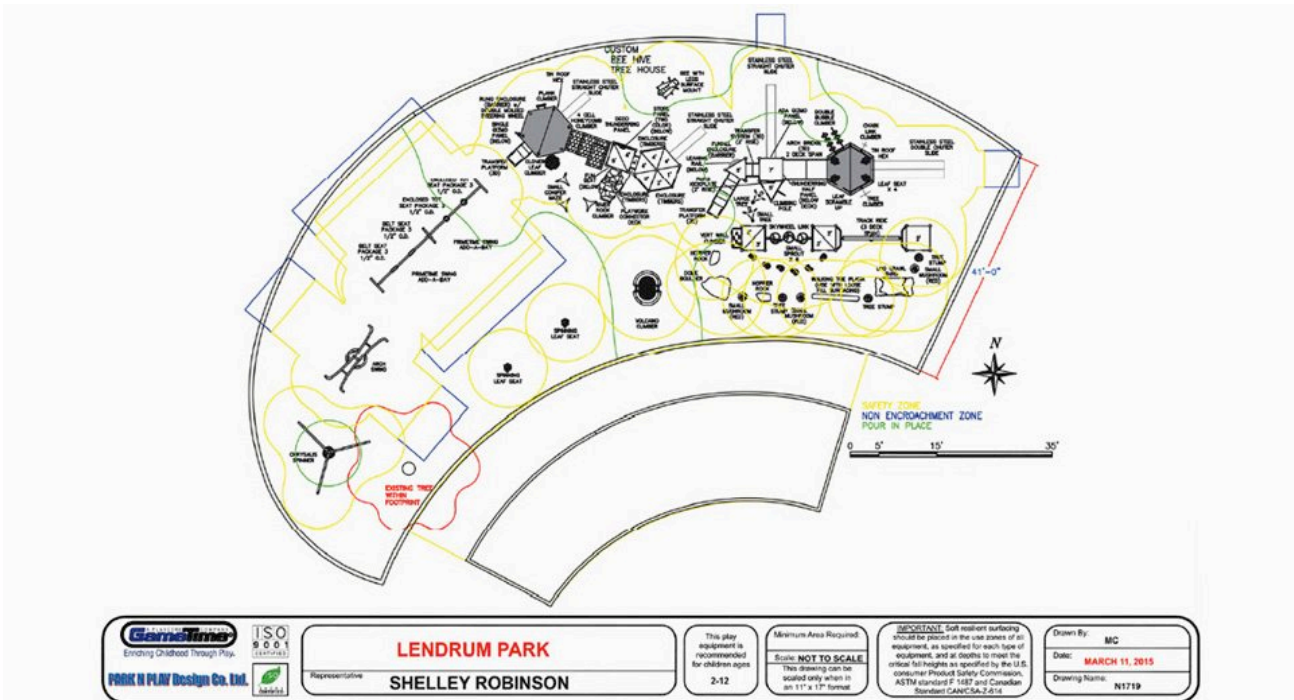

The Lendrum Park Redevelopment Committee is pleased to present the final design for the new playground! Our new playground is nature themed, featuring a custom tree play structure, tree climbers and stumps, a disc swing, a chrysalis spinner, a rock climbing volcano wall, spinning leaf seats, a double slide and an enormous bee complete with honeycomb climber!

The cost of the playground phase is \$440,000, of which \$47,000 was contributed by Lendrum Community League and an amazing \$62,000 from the community in the form of private donations and community fundraising! Construction should begin this July. The Grand Opening is tentatively planned for Community League Day, Saturday September 19th.



A central piece of our nature-themed playground is a magnificent **Custom Tree**. Children can explore the inside of the tree or experience the opportunities for climbing.





Our **Bee** will be a fun, educational climber for preschool and school aged children. Constructed of Glass Fiber Reinforced Concrete (GFRC) and exquisitely detailed to inspire a child's imagination, we think it will BEE a big hit!



Children will love the spinning sensation as they stand to turn themselves on the **Chrysalis-Spinner** or spin collaboratively with the help of others.



**The Arch Swing** is a fun and accessible way to add swinging motion to our playground. The wide seating area accommodates up to five children and is constructed of durable steel with a soft rubber bumper. Children can lay across the center section and enjoy the calming to-and-fro motion. Children can also sit around the perimeter of the seat and enjoy swinging together.



Our playground will be abuzz as children venture into the honeycomb to discover the exciting world of bees. This **Honeycomb Climber** promotes imaginative play as children climb from cell to cell, or gather to socialize with friends. The tactile hexagonal designs provide sensory benefits as children learn about the realistic honeycomb shapes, and the side view ports allow visibility into and out of the honeycomb to promote interactive play with parents or with other children.



The **Volcano Climbing Wall** provides a fun and challenging climbing experience for children. It features cave-like viewing portals for increased visibility and side ladders lead to a lookout platform at the top

**Last update: October 2015**